

TEMPORARY TRAFFIC CONTROL TYPICAL APPLICATION

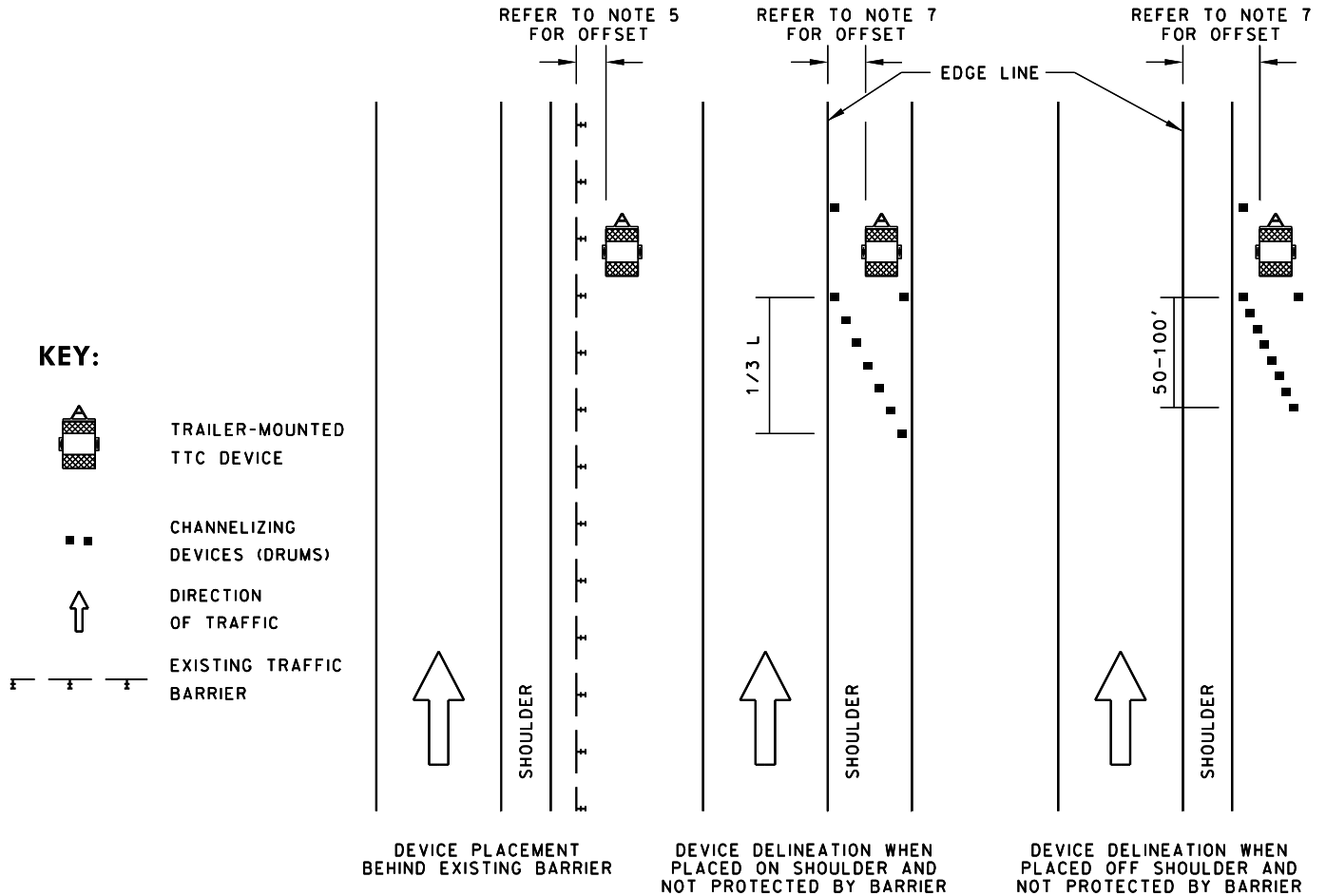

NOTES:

1. THIS DRAWING APPLIES TO PLACEMENT OF PORTABLE CHANGEABLE MESSAGE SIGN (PCMS), WORKERS PRESENT TRAILER (WPT), AND SPEED DISPLAY TRAILER (SDT).
2. THIS DRAWING ALSO APPLIES TO TRAILER-MOUNTED TTC DEVICE PLACEMENT ON OR ALONG A MEDIAN SHOULDER.
3. TRAILER-MOUNTED TTC DEVICE SHOULD BE PLACED BEHIND EXISTING TRAFFIC BARRIER, WHEN FEASIBLE.
4. ON LONG TERM PROJECTS, WHERE EXISTING TRAFFIC BARRIER IS NOT AVAILABLE TO SHIELD THE DEVICE, THE DEVICE SHOULD BE INSTALLED BEHIND TEMPORARY BARRIER, OR AS DIRECTED BY THE ENGINEER.
5. WHEN A TRAILER-MOUNTED TTC DEVICE IS PLACED BEHIND A TRAFFIC BARRIER, IT SHALL BE LOCATED A MINIMUM OF 4' FROM THE FACE OF CONCRETE BARRIER OR 6' FROM THE FACE OF W-BEAM UNLESS OTHERWISE APPROVED BY THE ENGINEER.
6. WHEN TEMPORARY BARRIER IS INSTALLED TO PROTECT THE DEVICE, IT SHALL BE DELINEATED PER MD 104.01-23A, 104.01-23B OR OTHER APPLICABLE STANDARDS.
7. WHEN NOT BEHIND BARRIER, THE TRAILER-MOUNTED TTC DEVICE SHALL BE DELINEATED (SEE NOTE 8). THE TRAILER-MOUNTED TTC DEVICE SHOULD BE PLACED A MINIMUM OF 6' FROM THE EDGE LINE OR 2' FROM FACE OF CURB.
8. UNLESS APPROVED BY THE ENGINEER, DRUMS SHALL BE USED FOR DELINEATION. THERE SHALL BE A MINIMUM OF NINE CHANNELIZING DEVICES: A MINIMUM OF SEVEN CHANNELIZING DEVICES IN THE SHOULDER TAPER PLUS TWO ADDITIONAL CHANNELIZING DEVICES NEAR THE CORNERS OF THE TRAILER-MOUNTED TTC DEVICE, ONE UPSTREAM AND ONE DOWNSTREAM AS SHOWN IN THE STANDARD. REFER TO MD 104.01-80 FOR DETERMINING TAPER LENGTH L.

SPECIFICATION	CATEGORY CODE ITEMS		
APPROVED	 DIRECTOR - OFFICE OF TRAFFIC AND SAFETY		
APPROVAL REVISIONS	SHA	APPROVAL	FEDERAL HIGHWAY ADMINISTRATION
APPROVAL	8-20-03	APPROVAL	9-23-03
REVISED	8-11-10	REVISED	7-29-10
REVISED	04-07-26	REVISED	04-02-26
REVISED		REVISED	

MDOT MARYLAND DEPARTMENT OF TRANSPORTATION
STATE HIGHWAY ADMINISTRATION

STANDARDS FOR HIGHWAYS AND INCIDENTAL STRUCTURES
TRAILER-MOUNTED DEVICES
PLACEMENT - ALL ROADWAYS/ALL SPEEDS

STANDARD NO. MD 104.01-22