

BEACH ELEMENTARY SCHOOL

NOTE
 THE CONTRATOR IS TO CONTACT MR. JOHN WILLIAMS PRINCIPAL OF THE SCHOOL TO ASCERTAIN THE LOCATION OF THE SWITCH.

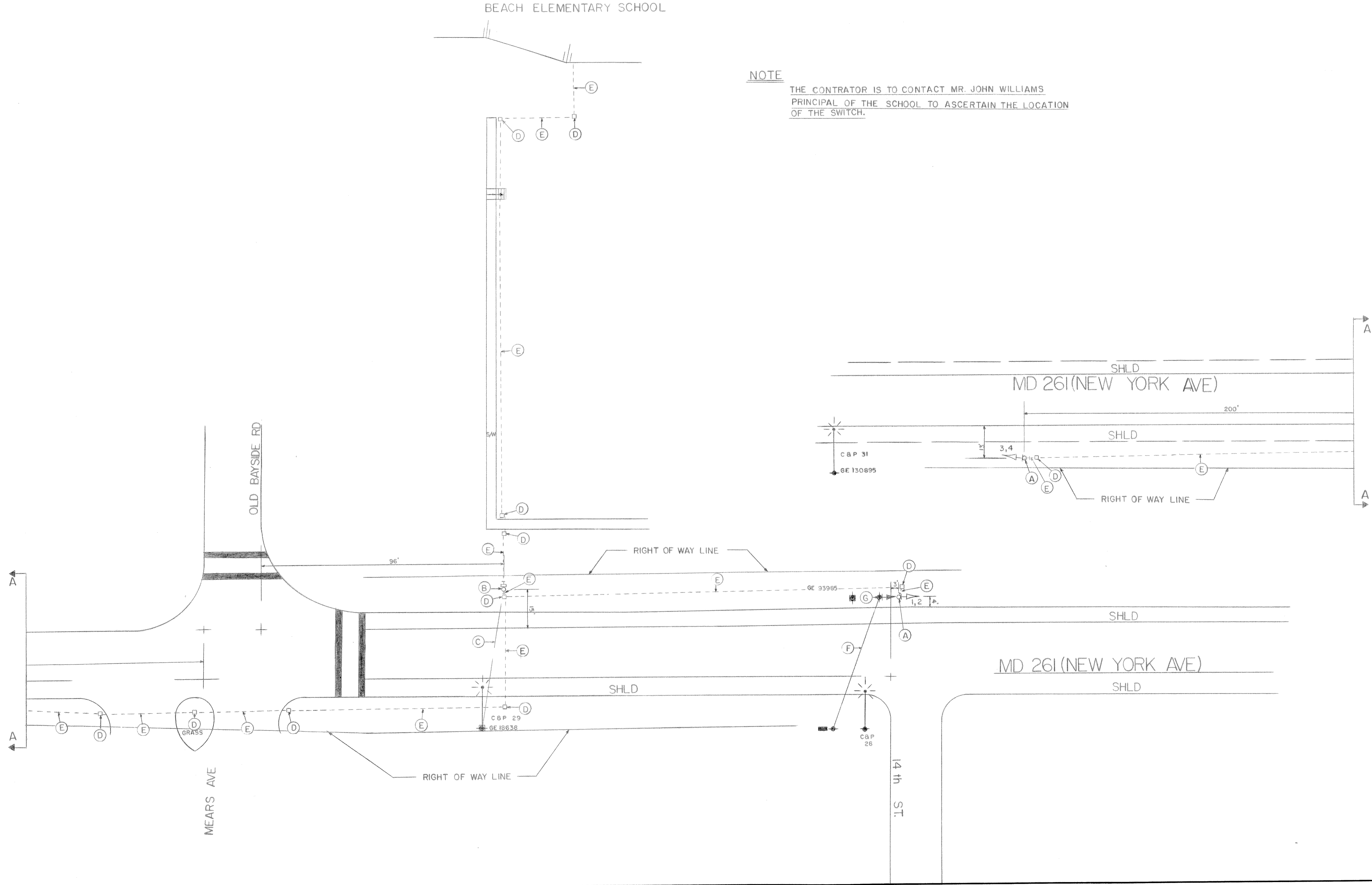

 APPROVAL: REGIONAL TRAFFIC ENGINEER	
 APPROVAL: CHIEF-BUREAU OF TRAFFIC ENGINEERING	
 APPROVAL: ASST. CHIEF ENGINEER TRAFFIC	
REVISIONS	

STATE OF MARYLAND
 DEPARTMENT OF TRANSPORTATION
 STATE HIGHWAY ADMINISTRATION
 TRAFFIC DIVISION - BUREAU OF TRAFFIC ENGINEERING

MD 261 AT BEACH ELEMENTARY SCHOOL

SCALE: 1"=20' DATE: 9-5-78 CONTRACT NO.: AW 359-506-085

DRAWN BY: BRUCE THOMPSON COUNTY: CALVERT

DESIGNED BY: Bruce Thompson SIGNAL NO.:

CHECKED BY: DATE: 9/6/78 DRAWING NO. TS-1614