

**CONSTRUCTION DETAILS**

- A. DISCONNECT AND REMOVE EXISTING OVERHEAD ELECTRICAL SERVICE.
- B. REMOVE EXISTING STEEL POLE AND ALL ATTACHED EQUIPMENT.
- C. REMOVE EXISTING HANDHOLE.
- D. CAP AND ABANDON EXISTING CONDUIT.
- E. REMOVE EXISTING RISERS, FOR SIGNAL CABLE, ON EXISTING WOOD POLE.
- F. REMOVE SPAN WIRE AND ALL ATTACHMENTS.
- G. REMOVE INTERCONNECT CABLE.

MD 450 ASSUMED TO RUN IN AN EAST-WEST DIRECTION

**SIGNS**

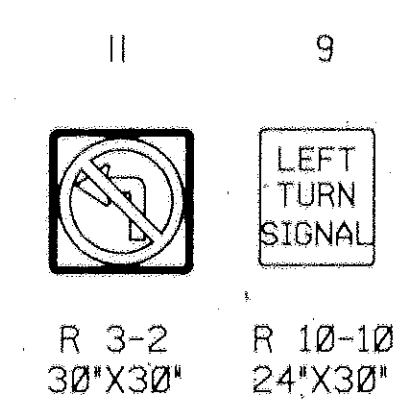

**SIGNALS**

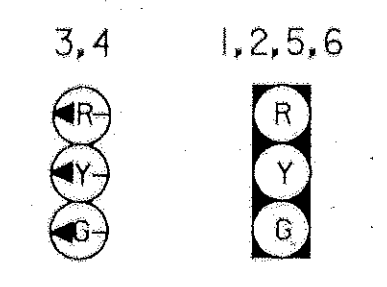

**NEMA PHASING**

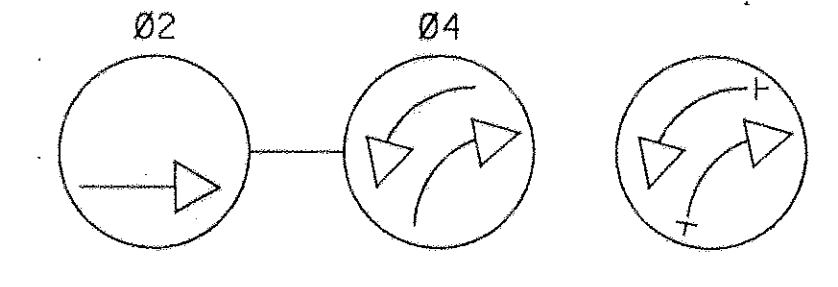

**PHASING NOTES**

- 1. PHASES ASSOCIATED BY A DASHED LINE WILL OPERATE CONCURRENTLY
- 2. PHASES ASSOCIATED BY A SOLID LINE WILL NOT OPERATE CONCURRENTLY

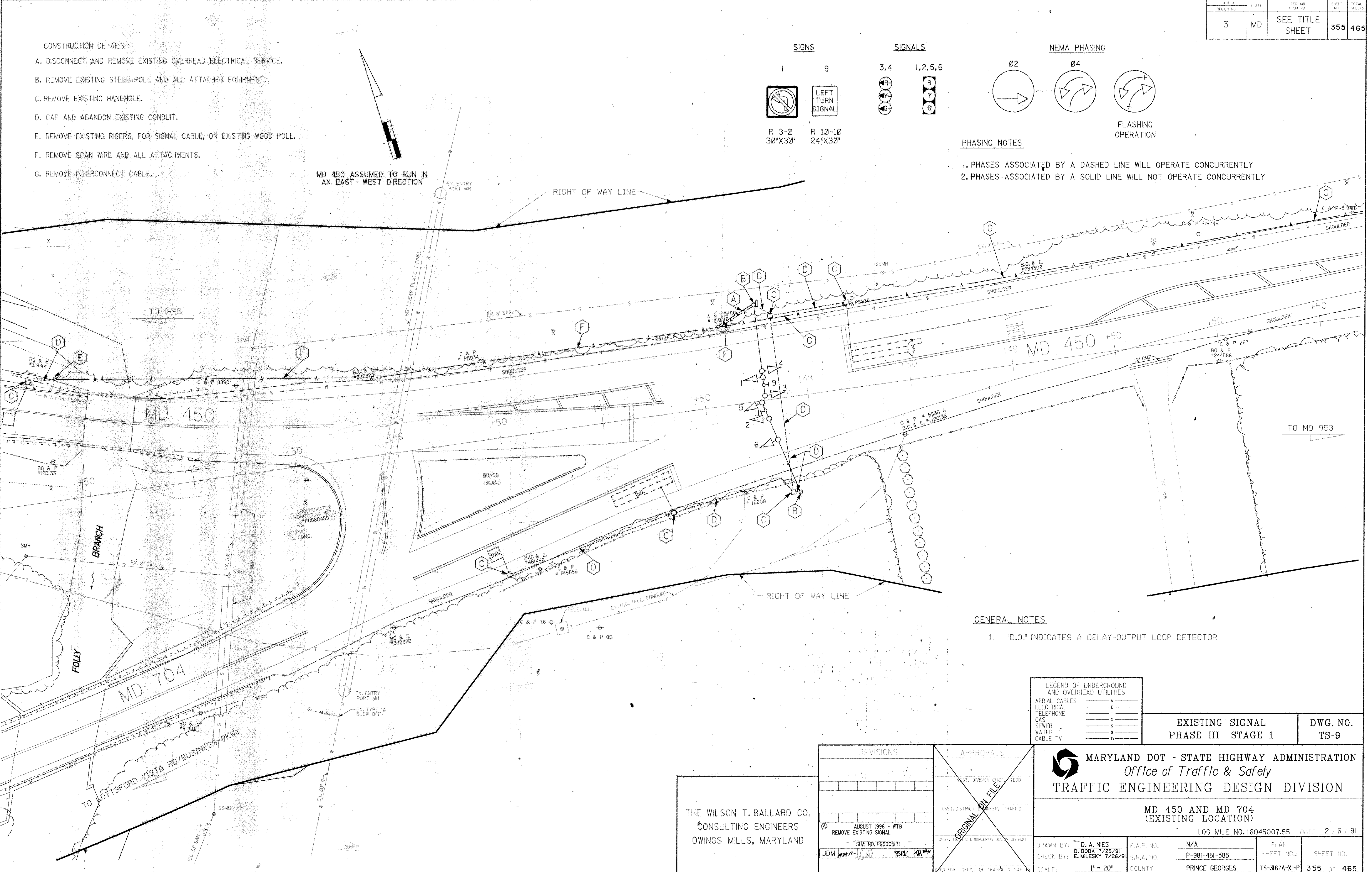

**GENERAL NOTES**

- 1. "D.O." INDICATES A DELAY-OUTPUT LOOP DETECTOR

**LEGEND OF UNDERGROUND AND OVERHEAD UTILITIES**

AERIAL CABLES	A
ELECTRICAL	E
TELEPHONE	T
GAS	G
SEWER	S
WATER	W
CABLE TV	TV

EXISTING SIGNAL PHASE III STAGE 1	DWG. NO. TS-9
--------------------------------------	------------------

THE WILSON T. BALLARD CO.  
CONSULTING ENGINEERS  
OWINGS MILLS, MARYLAND

REVISIONS	APPROVALS
AUGUST 1996 - WTB REMOVE EXISTING SIGNAL SHEET NO. PG9005171 JDM	DIVISION CHIEF, TEDD ASST. DISTRICT ENGINEER, TRAFFIC CHIEF, TRAFFIC ENGINEERING DESIGN DIVISION DIRECTOR, OFFICE OF TRAFFIC & SAFETY

**MARYLAND DOT - STATE HIGHWAY ADMINISTRATION**  
Office of Traffic & Safety  
**TRAFFIC ENGINEERING DESIGN DIVISION**

MD 450 AND MD 704 (EXISTING LOCATION)			
LOG MILE NO. 16045007.55 DATE 2 / 6 / 91			
DRAWN BY: D. A. NIES	F.A.P. NO. N/A	PLAN SHEET NO. TS-3167A-XI-P	SHEET NO. 355 OF 465
CHECK BY: D. DODA 7/25/91 E. MILESKY 7/26/91	S.H.A. NO. P-981-451-385	COUNTY PRINCE GEORGES	
SCALE: 1" = 20'			