

FLASHING OPERATION

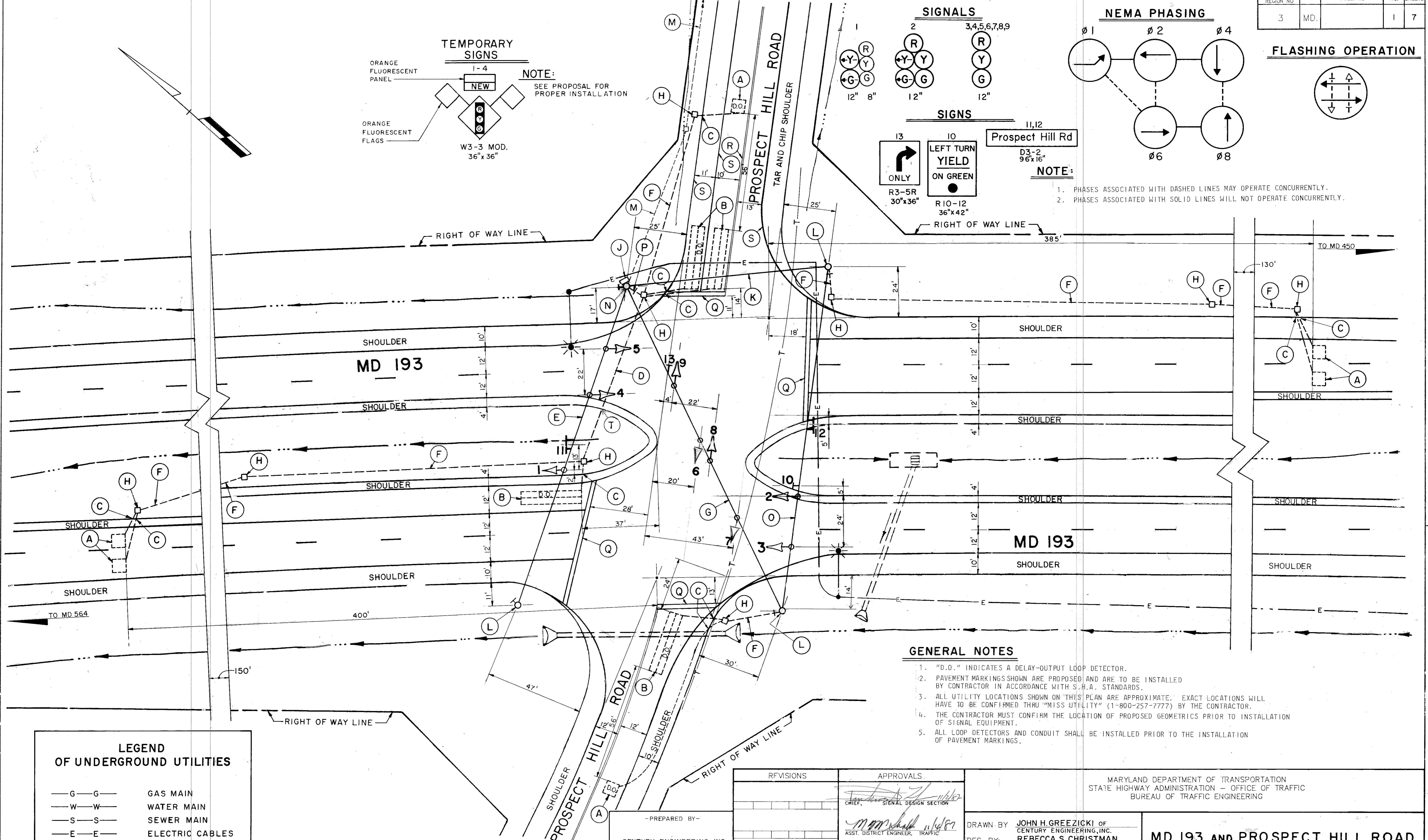
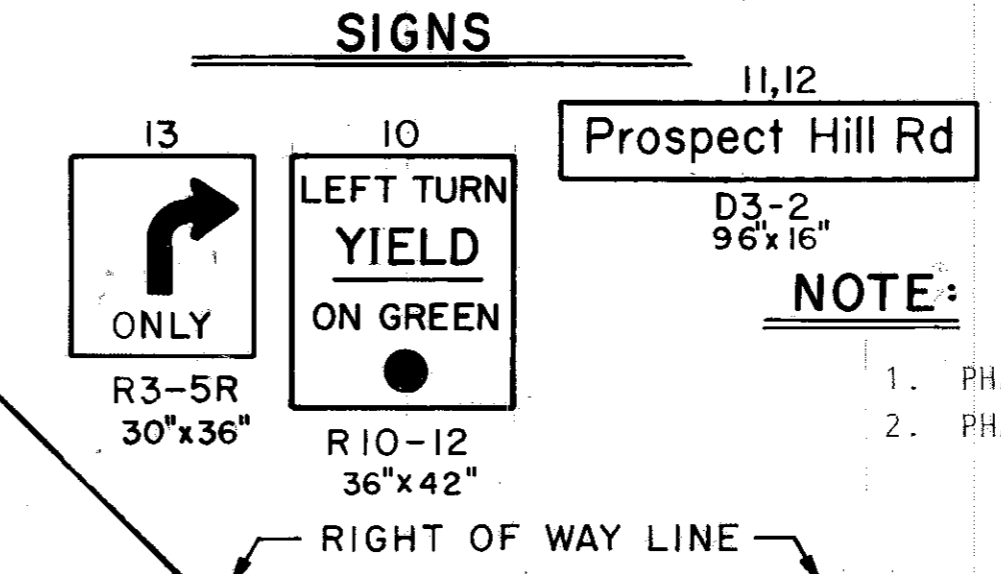
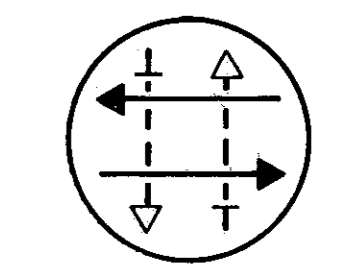

GENERAL NOTES

1. "D.O." INDICATES A DELAY-OUTPUT LOOP DETECTOR.
2. PAVEMENT MARKINGS SHOWN ARE PROPOSED AND ARE TO BE INSTALLED BY CONTRACTOR IN ACCORDANCE WITH S.H.A. STANDARDS.
3. ALL UTILITY LOCATIONS SHOWN ON THIS PLAN ARE APPROXIMATE. EXACT LOCATIONS WILL HAVE TO BE CONFIRMED THRU "MISS UTILITY" (1-800-257-7777) BY THE CONTRACTOR.
4. THE CONTRACTOR MUST CONFIRM THE LOCATION OF PROPOSED GEOMETRICS PRIOR TO INSTALLATION OF SIGNAL EQUIPMENT.
5. ALL LOOP DETECTORS AND CONDUIT SHALL BE INSTALLED PRIOR TO THE INSTALLATION OF PAVEMENT MARKINGS.

LEGEND OF UNDERGROUND UTILITIES

- G—G— GAS MAIN
- W—W— WATER MAIN
- S—S— SEWER MAIN
- E—E— ELECTRIC CABLES
- T—T— TELEPHONE CABLES
- A—A— AERIAL CABLES
- S/D—S/D— STORM DRAIN

—PREPARED BY—
CENTURY ENGINEERING, INC.
CONSULTING ENGINEERS-PLANNERS
TOWSON, MARYLAND

REVISIONS	APPROVALS
	<i>[Signature]</i> 11/16/87 CHIEF, SIGNAL DESIGN SECTION
	<i>[Signature]</i> 11/18/87 ASST. DISTRICT ENGINEER, TRAFFIC
	<i>[Signature]</i> 11/18/87 CHIEF, BUREAU OF TRAFFIC ENGINEERING
	<i>[Signature]</i> 11/18/87

MARYLAND DEPARTMENT OF TRANSPORTATION
STATE HIGHWAY ADMINISTRATION - OFFICE OF TRAFFIC
BUREAU OF TRAFFIC ENGINEERING

DRAWN BY: JOHN H. GREEZICKI OF CENTURY ENGINEERING, INC.
DES. BY: REBECCA S. CHRISTMAN, CENTURY ENGINEERING, INC.
CHK. BY: *[Signature]* 11/18/87

MD 193 AND PROSPECT HILL ROAD

DATE: JUNE 16, 1987 F.A.P. NO. _____ COUNTY: Prince Georges County
TS/SHEET NO. 177 SHEET NO. 7