

MD 146 IS ASSUMED TO RUN
IN A NORTH-SOUTH DIRECTION

SIGNALS

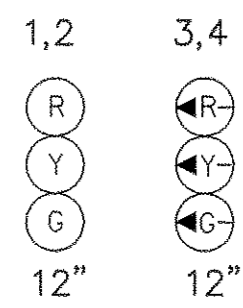

SIGNS

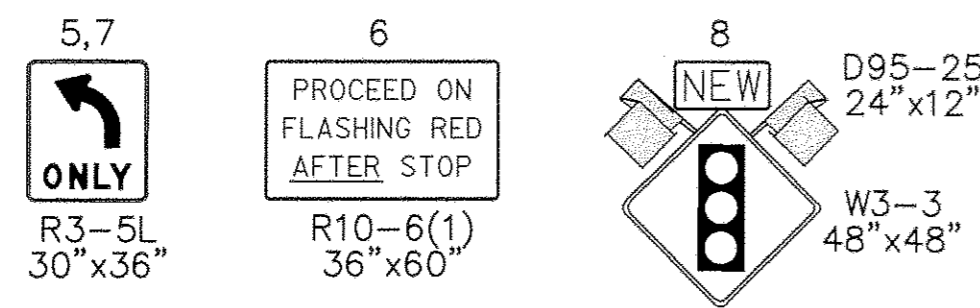

NEMA PHASING

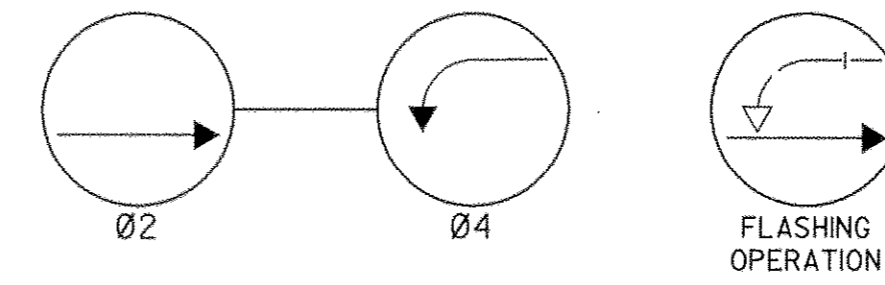

PHASING NOTES:
1. PHASES ASSOCIATED BY A SOLID LINE WILL NOT OPERATE CONCURRENTLY
2. PHASES ASSOCIATED BY A DASHED LINE WILL OPERATE CONCURRENTLY

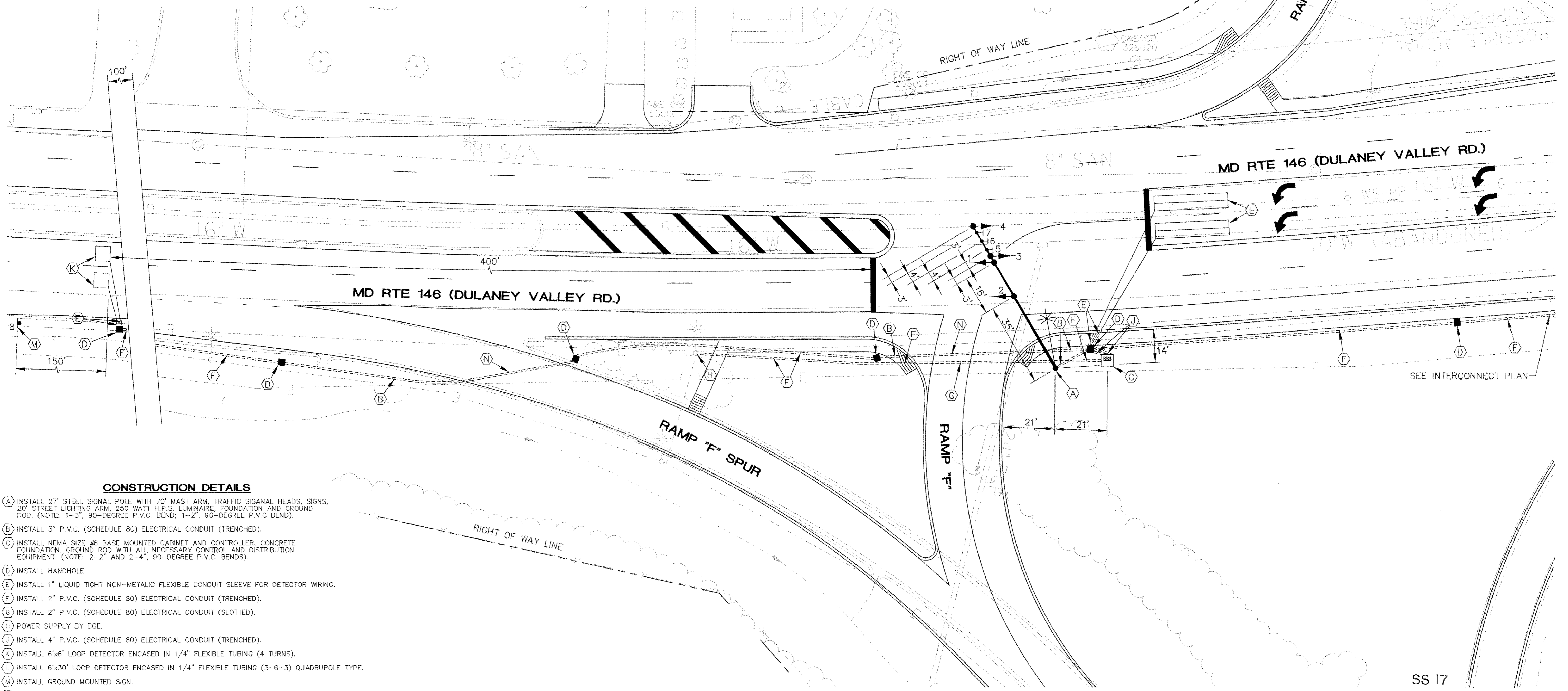

CONSTRUCTION DETAILS

- (A) INSTALL 27' STEEL SIGNAL POLE WITH 70' MAST ARM, TRAFFIC SIGNAL HEADS, SIGNS, 20' STREET LIGHTING ARM, 250 WATT H.P.S. LUMINAIRE, FOUNDATION AND GROUND ROD. (NOTE: 1-3", 90-DEGREE P.V.C. BEND; 1-2", 90-DEGREE P.V.C. BEND).
- (B) INSTALL 3" P.V.C. (SCHEDULE 80) ELECTRICAL CONDUIT (TRENCHED).
- (C) INSTALL NEMA SIZE #6 BASE MOUNTED CABINET AND CONTROLLER, CONCRETE FOUNDATION, GROUND ROD WITH ALL NECESSARY CONTROL AND DISTRIBUTION EQUIPMENT. (NOTE: 2-2" AND 2-4", 90-DEGREE P.V.C. BENDS).
- (D) INSTALL HANDHOLE.
- (E) INSTALL 1" LIQUID TIGHT NON-METALIC FLEXIBLE CONDUIT SLEEVE FOR DETECTOR WIRING.
- (F) INSTALL 2" P.V.C. (SCHEDULE 80) ELECTRICAL CONDUIT (TRENCHED).
- (G) INSTALL 2" P.V.C. (SCHEDULE 80) ELECTRICAL CONDUIT (SLOTTED).
- (H) POWER SUPPLY BY BGE.
- (J) INSTALL 4" P.V.C. (SCHEDULE 80) ELECTRICAL CONDUIT (TRENCHED).
- (K) INSTALL 6"x6" LOOP DETECTOR ENCASED IN 1/4" FLEXIBLE TUBING (4 TURNS).
- (L) INSTALL 6"x30" LOOP DETECTOR ENCASED IN 1/4" FLEXIBLE TUBING (3-6-3) QUADRUPOLE TYPE.
- (M) INSTALL GROUND MOUNTED SIGN.
- (N) INSTALL 3" P.V.C. (SCHEDULE 80) ELECTRICAL CONDUIT (SLOTTED).

UTILITY LEGEND

- G — G — GAS MAIN
- W — W — WATER MAIN
- S — S — SEWER MAIN
- SD — SD — STORM DRAIN
- TV — TV — CABLE TELEVISION
- E — E — ELECTRIC CABLES
- T — T — TELEPHONE CABLES
- A — A — AERIAL CABLES



A/E GROUP, INC.
ENGINEERS • PLANNERS
181 E. Main Street
Westminster, Maryland 21157
A/E Job No. 93-253-002

REVISIONS	APPROVALS
	<i>[Signature]</i> 11/27/98 CHIEF, SIGNAL DESIGN SECTION
	<i>[Signature]</i> 11/17/98 ASST. DISTRICT ENGINEER, TRAFFIC
	<i>[Signature]</i> 11/20/98 CHIEF, TRAFFIC ENGINEERING DESIGN DIVISION
	<i>[Signature]</i> DIRECTOR, OFFICE OF TRAFFIC & SAFETY

MDOT - STATE HIGHWAY ADMINISTRATION

Office of Traffic & Safety

TRAFFIC ENGINEERING DESIGN DIVISION LOG MI.

DRAWN BY: M.J.G.
DES. BY: A.T.H.
CHK. BY: C.S.C. *[Signature]*

**MD RTE 146 (DULANEY VALLEY RD.)
AT SPUR TO EASTBOUND I-695**

COUNTY: BALTIMORE

DATE: 09/29/98
SCALE: 1" = 20'

F.A.P. NO.
S.H.A. NO. BA9775372

TS/STD. NO.
3774

SHEET NO.
120 OF 155

SS 17