

BY: John Borkowski Division: P068 Highway Traff GMA Emp

DRILL HOLES

DRILL HOLES

DRILL HOLES

MD 30 IS CONSIDERED TO RUN IN A NORTH-SOUTH DIRECTION.

EXISTING SIGNALS & SIGNS

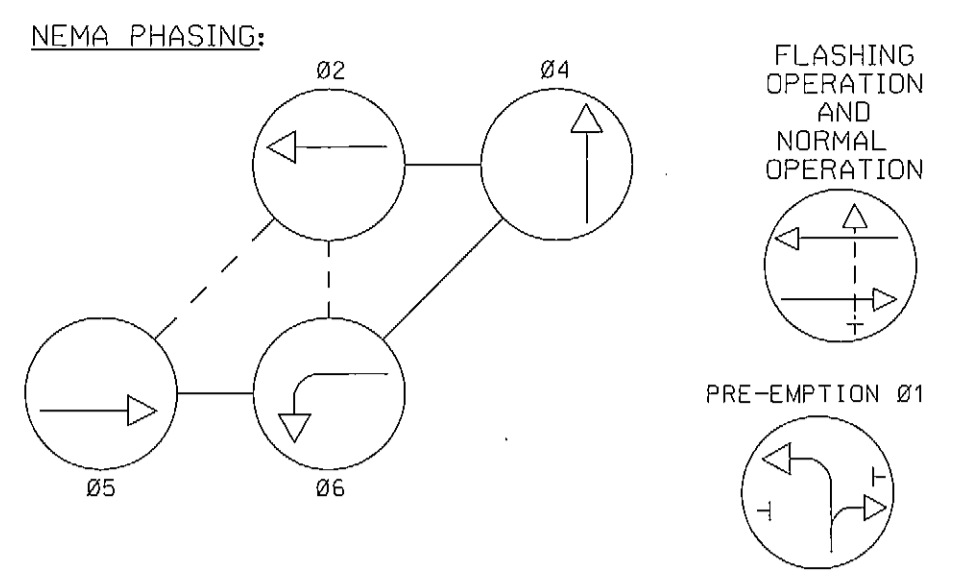
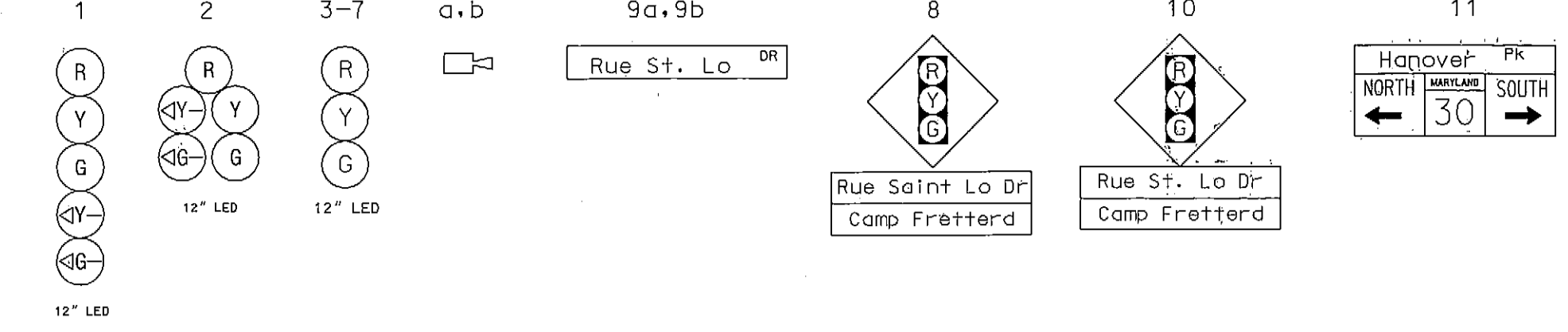

NEMA NOTES:
 1. PHASES ASSOCIATED BY A DASHED LINE WILL OPERATE CONCURRENTLY.
 2. PHASES ASSOCIATED BY A SOLID LINE WILL NOT OPERATE CONCURRENTLY.
 3. PHASES SHALL OPERATE FROM TUESDAY TO FRIDAY (6AM TO 7 AM AND 5 PM TO 6 PM).

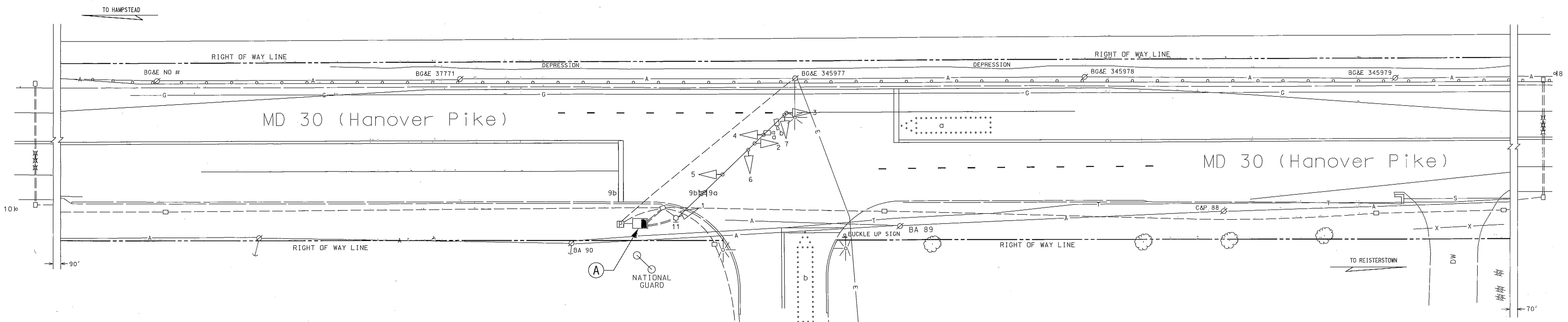

CONSTRUCTION DETAILS

A. REMOVE EXISTING SIZE '6' BASE MOUNTED CABINET AND INSTALL PROPOSED SIZE 'S' BASE MOUNTED CABINET WITH UPS EQUIPMENT ON EXISTING FOUNDATION.

EQUIPMENT LIST

A. EQUIPMENT TO BE SUPPLIED BY S.H.A.		
ITEM NO.	QUANTITY	DESCRIPTION
9104	1 EACH	CONTROLLER CABINET, SIZE "S" WITH CONTROLLER, VIDEO INTERFACE EQUIPMENT 1-8 CAMERAS
9110	1 EACH	UPS EQUIPMENT FOR "S" CABINET
B. EQUIPMENT TO BE FURNISHED AND INSTALLED BY THE CONTRACTOR		
ITEM NO.	QUANTITY	DESCRIPTION
1001	1 EACH	MAINTENANCE OF TRAFFIC
8014	1 EACH	INSTALL CONTROLLER AND CABINET - BASE MOUNT
8024	1 EACH	REMOVE & DISPOSE OF MATERIAL AND EQUIPMENT (PER ASSIGNMENT)
8065	1 EACH	INTERSECTION POLICE CONTROL

TOD NO: XY137-03
 SHA NO: BA035852
 Baltimore County UPS Phase 1

SHA STATE OF MARYLAND
 DEPARTMENT OF TRANSPORTATION
 STATE HIGHWAY ADMINISTRATION
 OFFICE OF TRAFFIC & SAFETY
 TRAFFIC ENGINEERING DESIGN DIVISION
 MD 30 (HANOVER PIKE) AND
 RUE SAINT LO DRIVE
 WOODENBURG, MARYLAND

KCI TECHNOLOGIES
 ENGINEERS
 PLANNERS
 SCIENTISTS
 CONSTRUCTION MANAGERS
 936 RIDGEBROOK ROAD
 SHARPS, MARYLAND 21152
 TELEPHONE: (410) 316-7800
 FAX: (410) 316-7818

APPROVALS	REVISIONS	SCALE	ADVERTISED DATE	CONTRACT NO.
ORIGINAL ON FILE	① - INSTALL UPS 03/2013	1"=20'	11/19/99	XX1005485
	SHA NO. XY1375185			
	KCI			
	DESIGNED BY: <i>R.M.J.B.S.</i>			COUNTY: BALTIMORE
	② - 10/2009 - INSTALL AN E/P LEFT TURN PHASE FOR N/B MD 30 ON A PARTTIME SIGNAL			
	SHA NO. XX4485185; TMS NO. J980			
	W/M			
	③ - 10/04/2007 - UPGRADE FITA TO NEW PART-TIME SIGNAL			
	SHA NO. A79365185; TMS NO. 1398			
	W/M			
	④ - 03/2013 - UPGRADE FITA TO NEW PART-TIME SIGNAL			
	SHA NO. A79365185; TMS NO. 1398			
	W/M			
	⑤ - 03/2013 - UPGRADE FITA TO NEW PART-TIME SIGNAL			
	SHA NO. A79365185; TMS NO. 1398			
	W/M			
	⑥ - 03/2013 - UPGRADE FITA TO NEW PART-TIME SIGNAL			
	SHA NO. A79365185; TMS NO. 1398			
	W/M			
	⑦ - 03/2013 - UPGRADE FITA TO NEW PART-TIME SIGNAL			
	SHA NO. A79365185; TMS NO. 1398			
	W/M			
	⑧ - 03/2013 - UPGRADE FITA TO NEW PART-TIME SIGNAL			
	SHA NO. A79365185; TMS NO. 1398			
	W/M			
	⑨ - 03/2013 - UPGRADE FITA TO NEW PART-TIME SIGNAL			
	SHA NO. A79365185; TMS NO. 1398			
	W/M			
	⑩ - 03/2013 - UPGRADE FITA TO NEW PART-TIME SIGNAL			
	SHA NO. A79365185; TMS NO. 1398			
	W/M			
	⑪ - 03/2013 - UPGRADE FITA TO NEW PART-TIME SIGNAL			
	SHA NO. A79365185; TMS NO. 1398			
	W/M			
	⑫ - 03/2013 - UPGRADE FITA TO NEW PART-TIME SIGNAL			
	SHA NO. A79365185; TMS NO. 1398			
	W/M			
	⑬ - 03/2013 - UPGRADE FITA TO NEW PART-TIME SIGNAL			
	SHA NO. A79365185; TMS NO. 1398			
	W/M			
	⑭ - 03/2013 - UPGRADE FITA TO NEW PART-TIME SIGNAL			
	SHA NO. A79365185; TMS NO. 1398			
	W/M			
	⑮ - 03/2013 - UPGRADE FITA TO NEW PART-TIME SIGNAL			
	SHA NO. A79365185; TMS NO. 1398			
	W/M			
	⑯ - 03/2013 - UPGRADE FITA TO NEW PART-TIME SIGNAL			
	SHA NO. A79365185; TMS NO. 1398			
	W/M			
	⑰ - 03/2013 - UPGRADE FITA TO NEW PART-TIME SIGNAL			
	SHA NO. A79365185; TMS NO. 1398			
	W/M			
	⑱ - 03/2013 - UPGRADE FITA TO NEW PART-TIME SIGNAL			
	SHA NO. A79365185; TMS NO. 1398			
	W/M			
	⑲ - 03/2013 - UPGRADE FITA TO NEW PART-TIME SIGNAL			
	SHA NO. A79365185; TMS NO. 1398			
	W/M			
	⑳ - 03/2013 - UPGRADE FITA TO NEW PART-TIME SIGNAL			
	SHA NO. A79365185; TMS NO. 1398			
	W/M			
	㉑ - 03/2013 - UPGRADE FITA TO NEW PART-TIME SIGNAL			
	SHA NO. A79365185; TMS NO. 1398			
	W/M			
	㉒ - 03/2013 - UPGRADE FITA TO NEW PART-TIME SIGNAL			
	SHA NO. A79365185; TMS NO. 1398			
	W/M			
	㉓ - 03/2013 - UPGRADE FITA TO NEW PART-TIME SIGNAL			
	SHA NO. A79365185; TMS NO. 1398			
	W/M			
	㉔ - 03/2013 - UPGRADE FITA TO NEW PART-TIME SIGNAL			
	SHA NO. A79365185; TMS NO. 1398			
	W/M			
	㉕ - 03/2013 - UPGRADE FITA TO NEW PART-TIME SIGNAL			
	SHA NO. A79365185; TMS NO. 1398			
	W/M			
	㉖ - 03/2013 - UPGRADE FITA TO NEW PART-TIME SIGNAL			
	SHA NO. A79365185; TMS NO. 1398			
	W/M			
	㉗ - 03/2013 - UPGRADE FITA TO NEW PART-TIME SIGNAL			
	SHA NO. A79365185; TMS NO. 1398			
	W/M			
	㉘ - 03/2013 - UPGRADE FITA TO NEW PART-TIME SIGNAL			
	SHA NO. A79365185; TMS NO. 1398			
	W/M			
	㉙ - 03/2013 - UPGRADE FITA TO NEW PART-TIME SIGNAL			
	SHA NO. A79365185; TMS NO. 1398			
	W/M			
	㉚ - 03/2013 - UPGRADE FITA TO NEW PART-TIME SIGNAL			
	SHA NO. A79365185; TMS NO. 1398			
	W/M			
	㉛ - 03/2013 - UPGRADE FITA TO NEW PART-TIME SIGNAL			
	SHA NO. A79365185; TMS NO. 1398			
	W/M			
	㉜ - 03/2013 - UPGRADE FITA TO NEW PART-TIME SIGNAL			
	SHA NO. A79365185; TMS NO. 1398			
	W/M			
	㉝ - 03/2013 - UPGRADE FITA TO NEW PART-TIME SIGNAL			
	SHA NO. A79365185; TMS NO. 1398			
	W/M			
	㉞ - 03/2013 - UPGRADE FITA TO NEW PART-TIME SIGNAL			
	SHA NO. A79365185; TMS NO. 1398			
	W/M			
	㉟ - 03/2013 - UPGRADE FITA TO NEW PART-TIME SIGNAL			
	SHA NO. A79365185; TMS NO. 1398			
	W/M			
	㊱ - 03/2013 - UPGRADE FITA TO NEW PART-TIME SIGNAL			
	SHA NO. A79365185; TMS NO. 1398			
	W/M			
	㊲ - 03/2013 - UPGRADE FITA TO NEW PART-TIME SIGNAL			
	SHA NO. A79365185; TMS NO. 1398			
	W/M			
	㊳ - 03/2013 - UPGRADE FITA TO NEW PART-TIME SIGNAL			
	SHA NO. A79365185; TMS NO. 1398			
	W/M			
	㊴ - 03/2013 - UPGRADE FITA TO NEW PART-TIME SIGNAL			
	SHA NO. A79365185; TMS NO. 1398			
	W/M			
	㊵ - 03/2013 - UPGRADE FITA TO NEW PART-TIME SIGNAL			
	SHA NO. A79365185; TMS NO. 1398			
	W/M			
	㊶ - 03/2013 - UPGRADE FITA TO NEW PART-TIME SIGNAL			
	SHA NO. A79365185; TMS NO. 1398			
	W/M			
	㊷ - 03/2013 - UPGRADE FITA TO NEW PART-TIME SIGNAL			
	SHA NO. A79365185; TMS NO. 1398			
	W/M			
	㊸ - 03/2013 - UPGRADE FITA TO NEW PART-TIME SIGNAL			
	SHA NO. A79365185; TMS NO. 1398			
	W/M			
	㊹ - 03/2013 - UPGRADE FITA TO NEW PART-TIME SIGNAL			
	SHA NO. A79365185; TMS NO. 1398			
	W/M			
	㊺ - 03/2013 - UPGRADE FITA TO NEW PART-TIME SIGNAL			
	SHA NO. A79365185; TMS NO. 1398			
	W/M			
	㊻ - 03/2013 - UPGRADE FITA TO NEW PART-TIME SIGNAL			
	SHA NO. A79365185; TMS NO. 1398			
	W/M			
	㊼ - 03/2013 - UPGRADE FITA TO NEW PART-TIME SIGNAL			
	SHA NO. A79365185; TMS NO. 1398			
	W/M			
	㊽ - 03/2013 - UPGRADE FITA TO NEW PART-TIME SIGNAL			
	SHA NO. A79365185; TMS NO. 1398			
	W/M			
	㊾ - 03/2013 - UPGRADE FITA TO NEW PART-TIME SIGNAL			
	SHA NO. A79365185; TMS NO. 1398			
	W/M			
	㊿ - 03/2013 - UPGRADE FITA TO NEW PART-TIME SIGNAL			
	SHA NO. A79365185; TMS NO. 1398			
	W/M			

PLOTTED: 12:48 PM on Thursday, March 07, 2013
 FILE: M:\2009\01090819.79\drawings\PSG-001_MD30@RueSaintLo.dwg