

NOTES:

1. ALL SHEET ALUMINUM SIGNS 5' WIDE AND LARGER SHALL BE BRACED WITH TWO HORIZONTAL 2"x4" TREATED WOOD OR EQUAL, ATTACHED TO THE SUPPORTS. THE BOLT LENGTHS SHALL BE COORDINATED.
2. ALL BOLTS SHALL BE 3/8" F593 (18-8 TYPE 303-304) STAINLESS STEEL OR ANODIZED ALUMINUM HEX HEAD BOLT WITH WASHERS AND NUTS SPACED AT 12" MAXIMUM.
3. S.S. 3 1/2" MIN. LAG BOLTS MAY BE SUBSTITUTED FOR HEX HEAD BOLTS. LAG BOLTS MUST BE STAGGERED AT 9" INTERVALS.

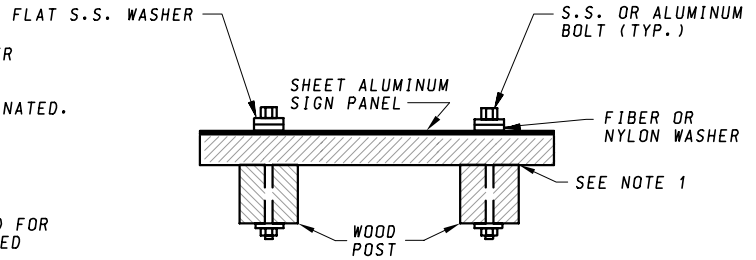

SHEET ALUMINUM SIGN PANEL

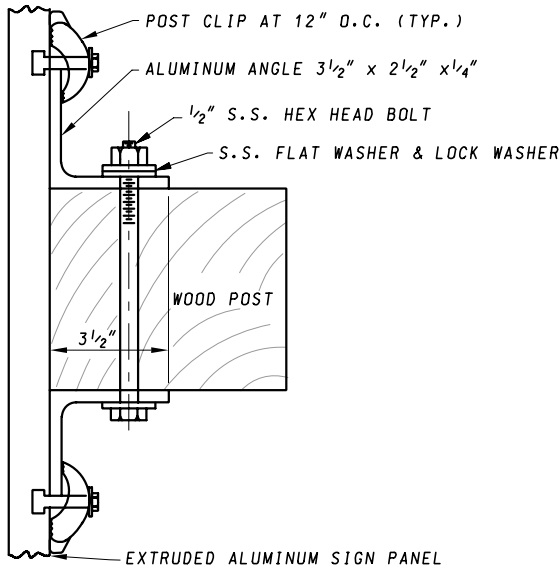
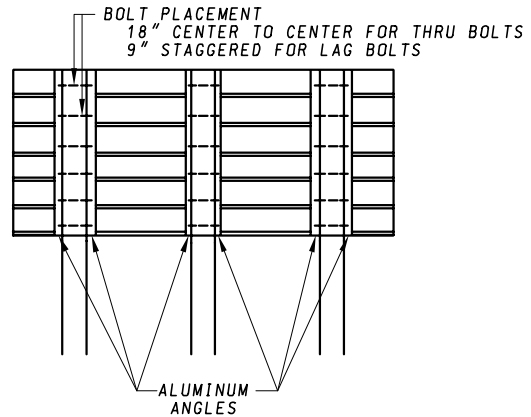

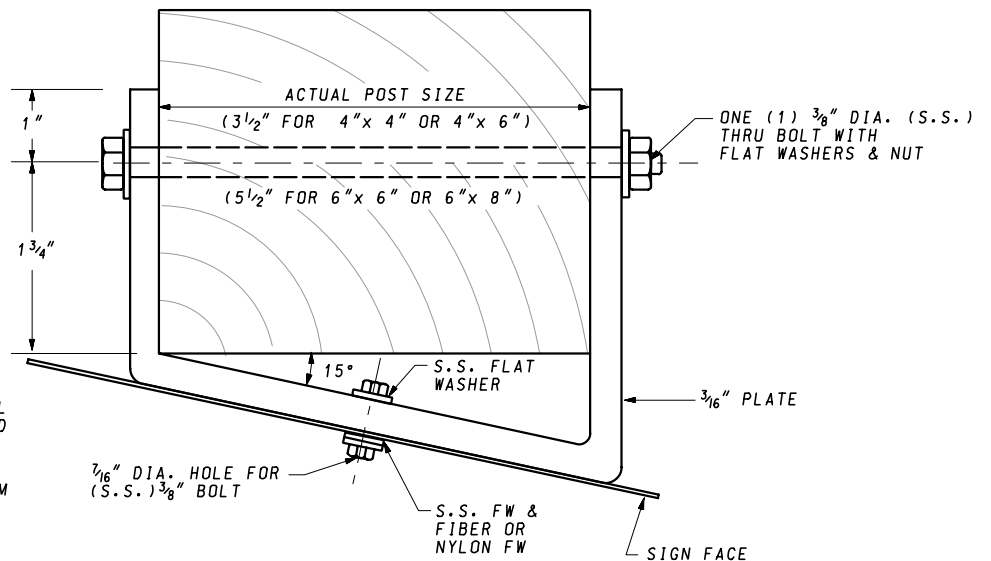

EXTRUDED ALUMINUM SIGN PANEL



CLAMP FOR SIGN MOUNTED AT 15 DEGREE ANGLE

NOTES:

1. INSTALL SIGN ON CLAMPS FIRST, AND THEN INSTALL ENTIRE ASSEMBLY ON WOOD POST.
2. TWO CLAMPS PER WOOD SUPPORT LOCATED 3" FROM TOP & BOTTOM OF SIGN.

SPECIFICATION 812, 813	CATEGORY CODE ITEMS	<p>Maryland Department of Transportation STATE HIGHWAY ADMINISTRATION STANDARDS FOR HIGHWAYS AND INCIDENTAL STRUCTURES</p> <p>WOOD SIGN SUPPORTS SIGN MOUNTING</p>
APPROVED	 DIRECTOR - OFFICE OF TRAFFIC AND SAFETY	
	APPROVAL • SHA REVISIONS	APPROVAL • FEDERAL HIGHWAY ADMINISTRATION
	APPROVAL 2-21-95	APPROVAL 2-21-95
	REVISED 5-17-07	REVISED 5-2-07
	REVISED	REVISED
	REVISED	REVISED
STANDARD NO.		MD 812.02