

PLAN

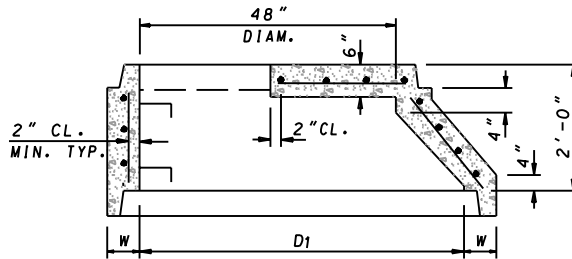

SECTION A-A

PRECAST MANHOLE DIAMETER	DIMENSIONS			
	D	D ₁	W	X
60"	6'-0"	5'-0"	6"	3'-6"
72"	7'-2"	6'-0"	7"	4'-7"

NOTES

1. THE COMBINATION ECCENTRIC CONE REDUCER AND DRIP STONE LANDING SHALL BE USED ONLY WHEN THERE ARE PIPES CONNECTED TO THE RISER UNITS. SEE STANDARD MD 384.13 FOR PLACEMENT.
2. CONCRETE SHALL BE MIX NO.6 (4500 PSI).
3. REINFORCEMENT SHALL BE REINFORCING BARS OR WELDED WIRE FABRIC WITH A MINIMUM AREA OF 0.15 IN. ²/FT FOR THE 60" DIAMETER CONE UNIT AND 0.18 IN. ²/FT FOR THE 72" DIAMETER CONE UNIT.
4. THE MANUFACTURER SHALL FORM MALE AND FEMALE ENDS OF JOINTS USING THEIR OWN DESIGN.
5. LIFT EYES SHALL BE PROVIDED FOR HANDLING.
6. COST FOR THE COMBINATION ECCENTRIC CONE REDUCER AND DRIP STONE LANDING IS INCIDENTAL TO THE COST OF THE MANHOLE.

SPECIFICATION	CATEGORY CODE ITEMS
---------------	---------------------

APPROVED *Kirk G. McCall*
DIRECTOR - OFFICE OF HIGHWAY DEVELOPMENT

	APPROVAL • SHA REVISIONS	APPROVAL • FEDERAL HIGHWAY ADMINISTRATION
	APPROVAL 2-22-91	APPROVAL 1-2-91
	REVISED 10-1-01	REVISED
	REVISED	REVISED

Maryland Department of Transportation
STATE HIGHWAY ADMINISTRATION
STANDARDS FOR HIGHWAYS AND INCIDENTAL STRUCTURES
PRECAST COMBINATION ECCENTRIC CONE REDUCER AND DRIP STONE LANDING FOR 60" AND 72" DIAMETER MANHOLES

STANDARD NO. MD 384.17