

TEMPORARY TRAFFIC CONTROL TYPICAL APPLICATION

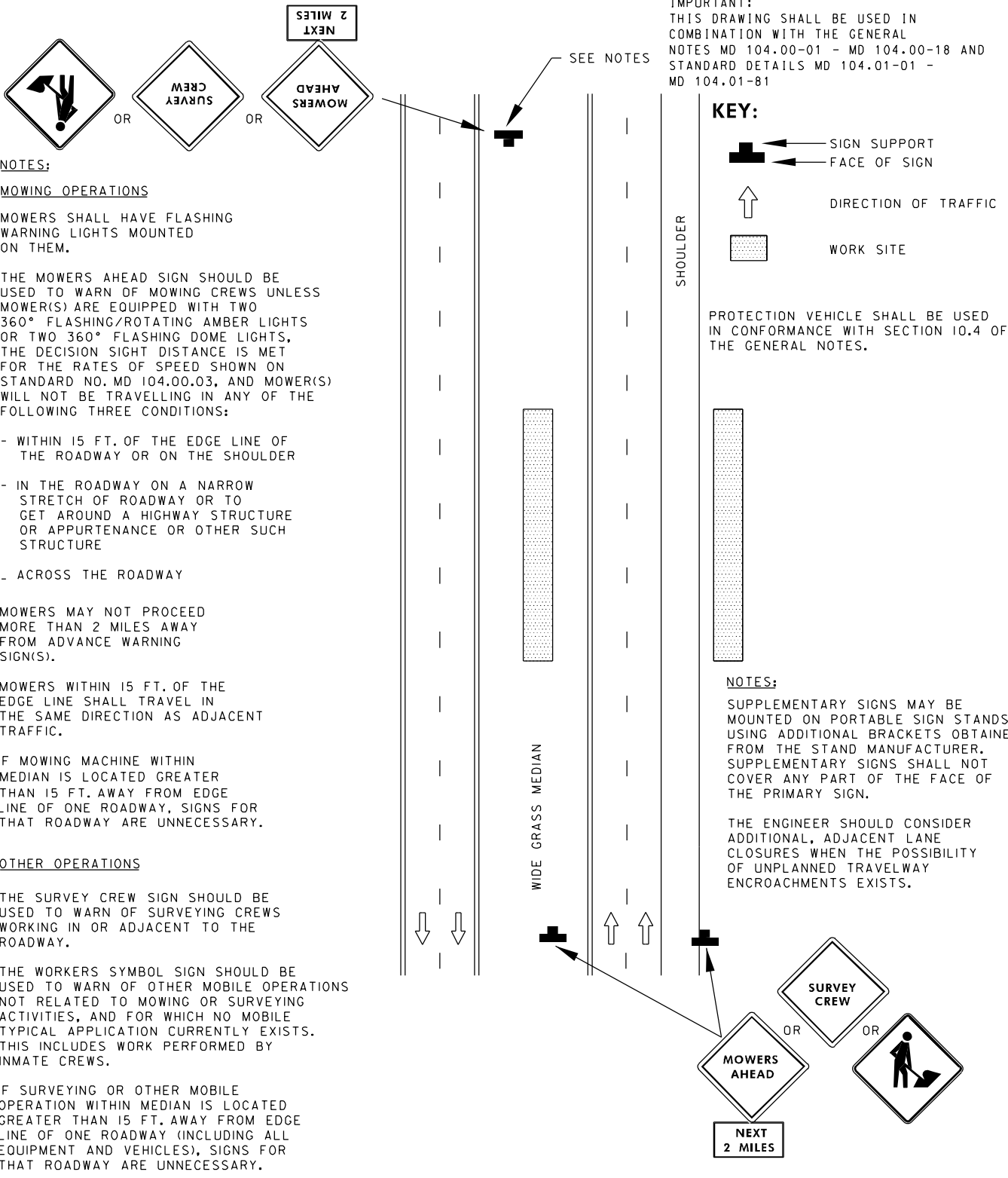

IMPORTANT:
 THIS DRAWING SHALL BE USED IN COMBINATION WITH THE GENERAL NOTES MD 104.00-01 - MD 104.00-18 AND STANDARD DETAILS MD 104.01-01 - MD 104.01-81

NOTES:

MOWING OPERATIONS

MOWERS SHALL HAVE FLASHING WARNING LIGHTS MOUNTED ON THEM.

THE MOWERS AHEAD SIGN SHOULD BE USED TO WARN OF MOWING CREWS UNLESS MOWER(S) ARE EQUIPPED WITH TWO 360° FLASHING/ROTATING AMBER LIGHTS OR TWO 360° FLASHING DOME LIGHTS, THE DECISION SIGHT DISTANCE IS MET FOR THE RATES OF SPEED SHOWN ON STANDARD NO. MD 104.00.03, AND MOWER(S) WILL NOT BE TRAVELLING IN ANY OF THE FOLLOWING THREE CONDITIONS:

- WITHIN 15 FT. OF THE EDGE LINE OF THE ROADWAY OR ON THE SHOULDER
- IN THE ROADWAY ON A NARROW STRETCH OF ROADWAY OR TO GET AROUND A HIGHWAY STRUCTURE OR APPURTENANCE OR OTHER SUCH STRUCTURE
- ACROSS THE ROADWAY

MOWERS MAY NOT PROCEED MORE THAN 2 MILES AWAY FROM ADVANCE WARNING SIGN(S).

MOWERS WITHIN 15 FT. OF THE EDGE LINE SHALL TRAVEL IN THE SAME DIRECTION AS ADJACENT TRAFFIC.

IF MOWING MACHINE WITHIN MEDIAN IS LOCATED GREATER THAN 15 FT. AWAY FROM EDGE LINE OF ONE ROADWAY, SIGNS FOR THAT ROADWAY ARE UNNECESSARY.

OTHER OPERATIONS

THE SURVEY CREW SIGN SHOULD BE USED TO WARN OF SURVEYING CREWS WORKING IN OR ADJACENT TO THE ROADWAY.

THE WORKERS SYMBOL SIGN SHOULD BE USED TO WARN OF OTHER MOBILE OPERATIONS NOT RELATED TO MOWING OR SURVEYING ACTIVITIES, AND FOR WHICH NO MOBILE TYPICAL APPLICATION CURRENTLY EXISTS. THIS INCLUDES WORK PERFORMED BY INMATE CREWS.

IF SURVEYING OR OTHER MOBILE OPERATION WITHIN MEDIAN IS LOCATED GREATER THAN 15 FT. AWAY FROM EDGE LINE OF ONE ROADWAY (INCLUDING ALL EQUIPMENT AND VEHICLES), SIGNS FOR THAT ROADWAY ARE UNNECESSARY.

SPECIFICATION	104	CATEGORY CODE ITEMS	
APPROVED	<i>Chic Wald</i>		
	DIRECTOR - OFFICE OF TRAFFIC AND SAFETY		
SHA State Highway Administration	APPROVAL • SHA REVISIONS	APPROVAL • FEDERAL HIGHWAY ADMINISTRATION	
	APPROVAL 8-20-03	APPROVAL 9-23-03	
	REVISED 8-11-10	REVISED 7-29-10	
	REVISED 8-20-14	REVISED 8-11-14	
	REVISED	REVISED	

Maryland Department of Transportation
STATE HIGHWAY ADMINISTRATION
 STANDARDS FOR HIGHWAYS AND INCIDENTAL STRUCTURES
MOBILE WORK OPERATION
DIVIDED UNCON. OR EXP-FREEWAY
ALL SPEEDS

STANDARD NO. MD 104.04-19