

PLAN VIEW

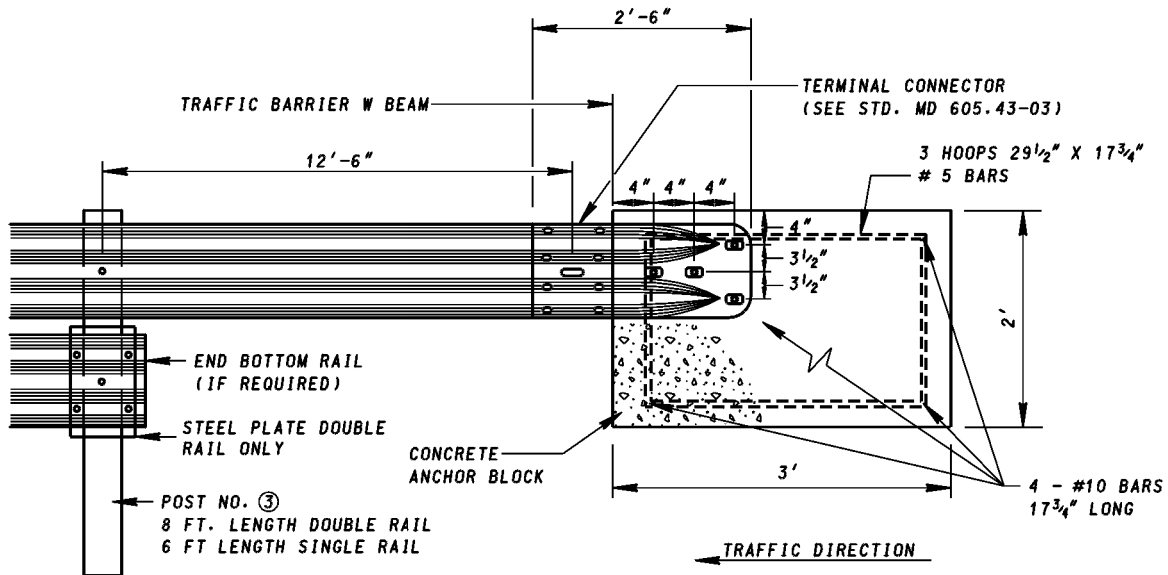

FRONT VIEW

NOTES

1. THE CONTRACTOR SHALL FURNISH AND INSTALL FOUR (4) $\frac{1}{8}$ " DIA X 10" LENGTH HEAVY DUTY GALV. THREADED ANCHOR RODS WITH HEX HEAD RECESSED NUTS AND RECTANGULAR PLATE WASHERS. ANCHOR RODS SHALL BE ANCHORED WITH EPOXY GROUT AS SPECIFIED IN SPEC. 902.
2. THIS OPTION REPLACES POSTS 1 AND 2 AS SHOWN IN OPTION 1
3. CONCRETE ANCHOR BLOCK MAY BE PRECAST OR CAST IN PLACE.
4. THE COST OF THE TERMINAL CONNECTOR SHALL BE INCIDENTAL TO THE CONTRACT PRICE PER EACH FOR THE TYPE A END ANCHORAGE TERMINAL.

SPECIFICATION 605	CATEGORY CODE ITEMS
APPROVED	<i>Raff</i> DIRECTOR - OFFICE OF HIGHWAY DEVELOPMENT
	APPROVAL • SHA REVISIONS
	APPROVAL 11-10-99
	REVISED 9-30-04
	REVISED
	REVISED
	APPROVAL • FEDERAL HIGHWAY ADMINISTRATION
	APPROVAL 7-2-99
	REVISED 3-28-01
	REVISED
	REVISED

Maryland Department of Transportation
STATE HIGHWAY ADMINISTRATION
 STANDARDS FOR HIGHWAYS AND INCIDENTAL STRUCTURES
TRAFFIC BARRIER W BEAM WITH
TYPE A END ANCHORAGE
(OPTION 2)

STANDARD NO. MD 605.01-03