

SIGN SIZE (SQUARE FEET)	Y ₁	Y ₂
1 - 16	1'-0"	1'-6"
17 - 45	2'-0"	2'-6"

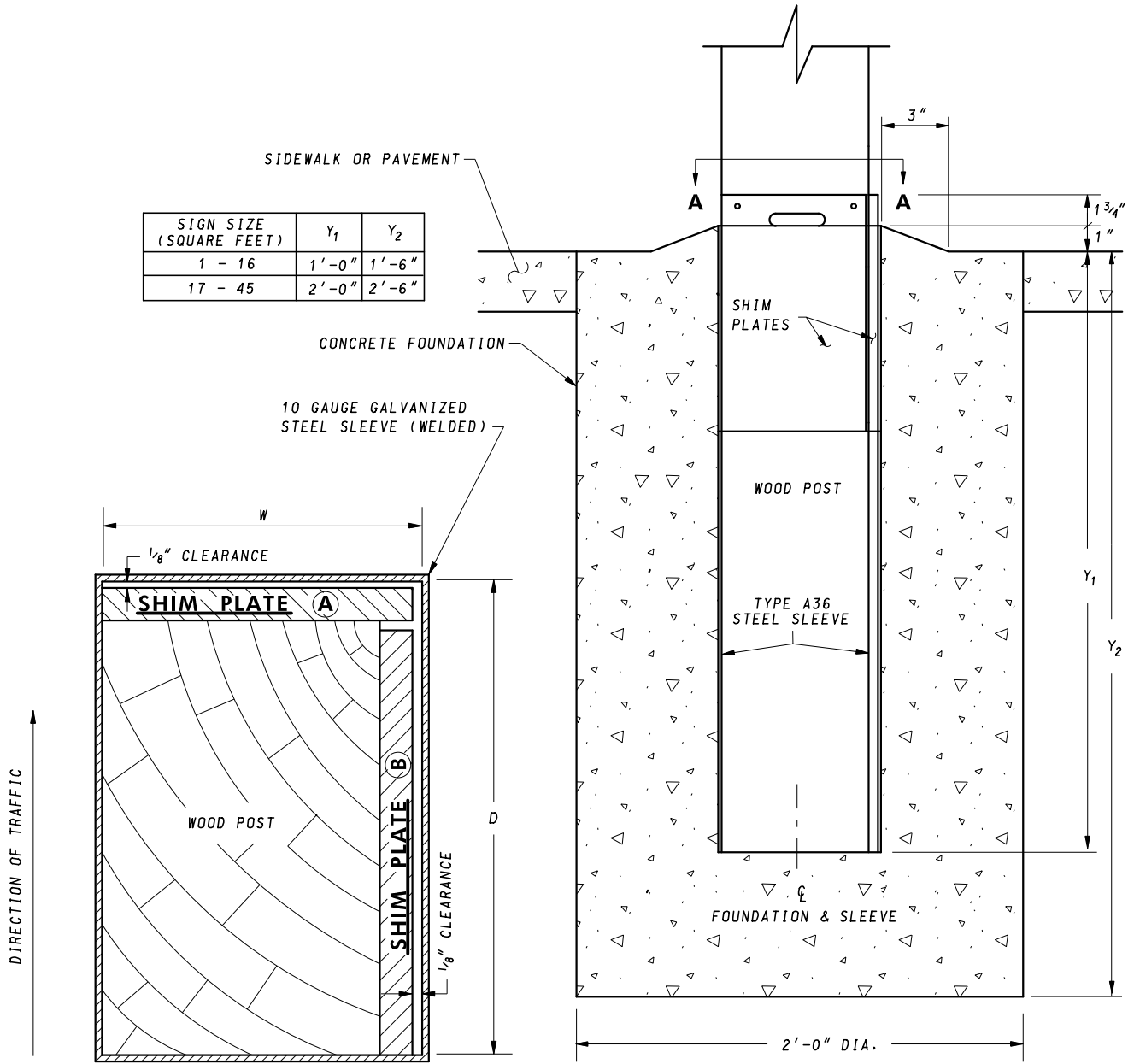

SECTION A-A

WOOD SIGN SUPPORT SIZE	W	D
4" x 4"	4 1/2"	4 1/2"
4" x 6"	4 1/2"	6 1/2"
6" x 6"	6 1/2"	6 1/2"
6" x 8"	6 1/2"	8 1/4"

NOTE:

REFER TO OTHER WOOD SIGN SUPPORT SLEEVED FOUNDATION STANDARD PLATE FOR SHIM PLATE DETAILS.

SPECIFICATION 801, 812	CATEGORY CODE ITEMS
APPROVED	<i>Cedric Wall</i> DIRECTOR - OFFICE OF TRAFFIC AND SAFETY
APPROVAL SHA REVISIONS	APPROVAL FEDERAL HIGHWAY ADMINISTRATION
APPROVAL 2-21-95	APPROVAL 2-21-95
REVISED 8-5-10	REVISED 12-22-09
REVISED 11-10-18	REVISED 10-26-18
REVISED	REVISED

MOT MARYLAND DEPARTMENT OF TRANSPORTATION
STATE HIGHWAY ADMINISTRATION

STANDARDS FOR HIGHWAYS AND INCIDENTAL STRUCTURES

**WOOD SIGN SUPPORTS
SLEEVED FOUNDATION**

STANDARD NO. MD 812.05-01