

SHA
SIGN SHALL NOT BE USED ALONG STATE OWNED, OPERATED AND MAINTAINED ROADWAYS.

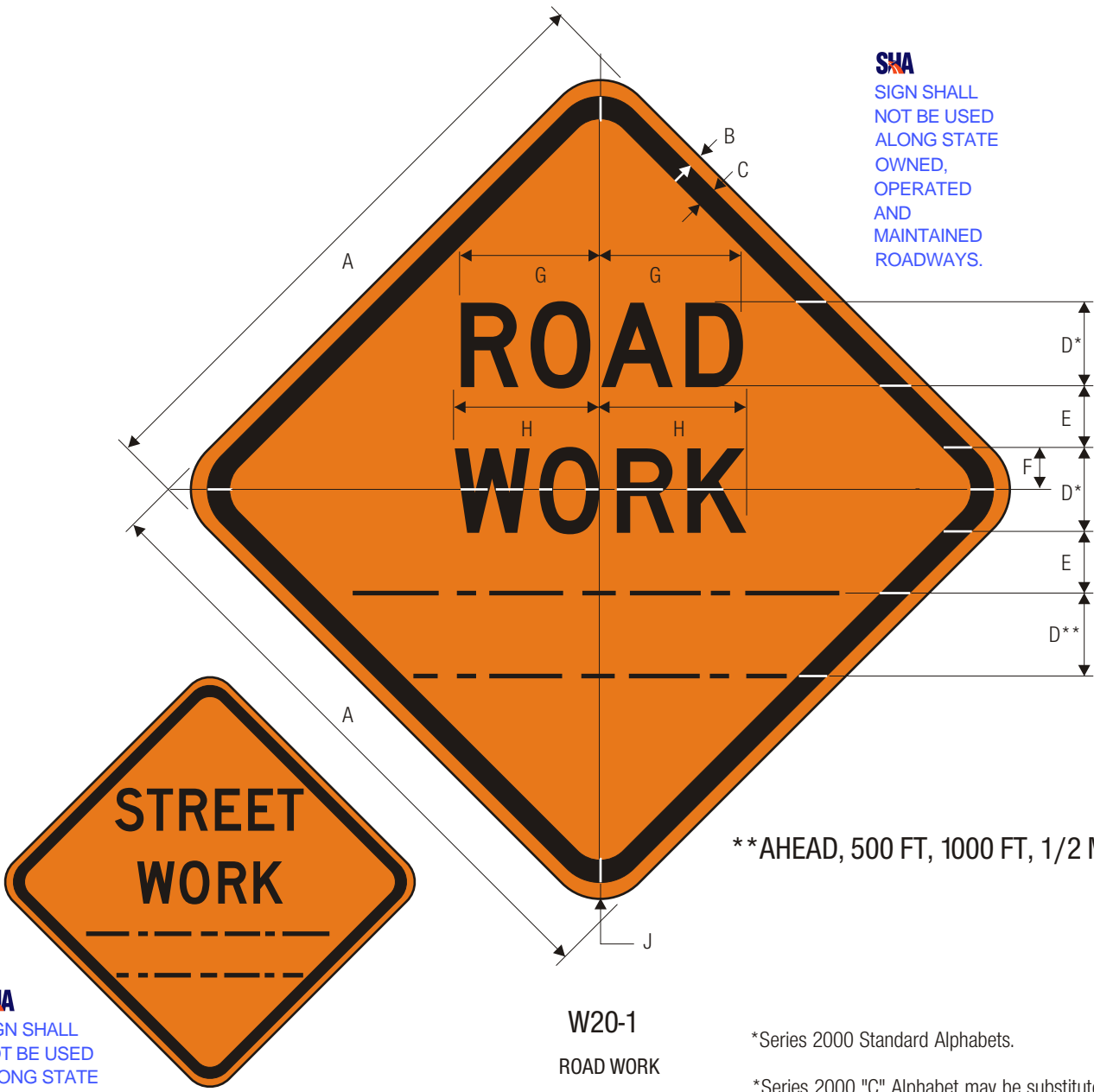

**AHEAD, 500 FT, 1000 FT, 1/2 MILE

SHA
SIGN SHALL NOT BE USED ALONG STATE OWNED, OPERATED AND MAINTAINED ROADWAYS.

W20-1
ROAD WORK

*Series 2000 Standard Alphabets.
*Series 2000 "C" Alphabet may be substituted where space limitations occur due to length of word message.

	A	B	C	D	E	F	G	H	J
	24	.375	.625	4 D	2	2	6.685	6.965	1.5
	30	.5	.75	4 D	2.742	2	6.685	6.965	1.875
C	36	.625	.875	5 D	3.682	2.481	8.406	8.666	2.25
	48	.75	1.25	7 D	4.803	3.482	11.688	11.788	3
	60	.75	1.25	8 D	5.484	4	13.370	13.930	3

TTC SIGN COLORS:
LEGEND — BLACK
BACKGROUND— ORANGE (RETROREFLECTIVE)