

## TEMPORARY TRAFFIC CONTROL TYPICAL APPLICATION

**IMPORTANT:**  
THIS DRAWING SHALL BE USED IN COMBINATION WITH THE GENERAL NOTES MD 104.00-01 - MD 104.00-18 AND STANDARD DETAILS MD 104.01-01 - MD 104.01-81

**NOTES:**

SIMILAR SIGNING FOR OPPOSITE APPROACH SHALL BE REQUIRED.





WARNING LIGHTS SHALL BE USED TO MARK BARRICADES AT NIGHT AS NEEDED.

ROAD NAME PANELS (M4-9(1)) (BLK/WHT) SHALL BE USED FOR DIRECTING DETOURED TRAFFIC; PLACE IN SPACE PROVIDED ABOVE M4-9 SIGNS (\*).

THE OPTIONAL ROAD CLOSED AND EFFECTIVE SIGNS SHOULD BE PLACED TWO (2) WEEKS PRIOR TO THE ROAD CLOSURE. THE EFFECTIVE SIGN SHOULD BE REMOVED TWO DAYS AFTER THE ACTUAL DATE OF THE ROAD CLOSURE AND REPLACED WITH REOPENING INFORMATION. GENERAL INFORMATION REGARDING THE REOPENING DATE MAY BE POSTED UNTIL THE REOPENING DATE IS CONFIRMED. AT WHICH TIME THE REOPENS SIGNS WITH ACTUAL DATE SHOULD BE POSTED.

**EFFECTIVE XXX XX** - BLACK/YELLOW  
**REOPENS XXX XX** - BLACK/YELLOW

**KEY:**

-  SIGN SUPPORT
-  FACE OF SIGN
-  TYPE III BARRICADE
-  DIRECTION OF TRAFFIC

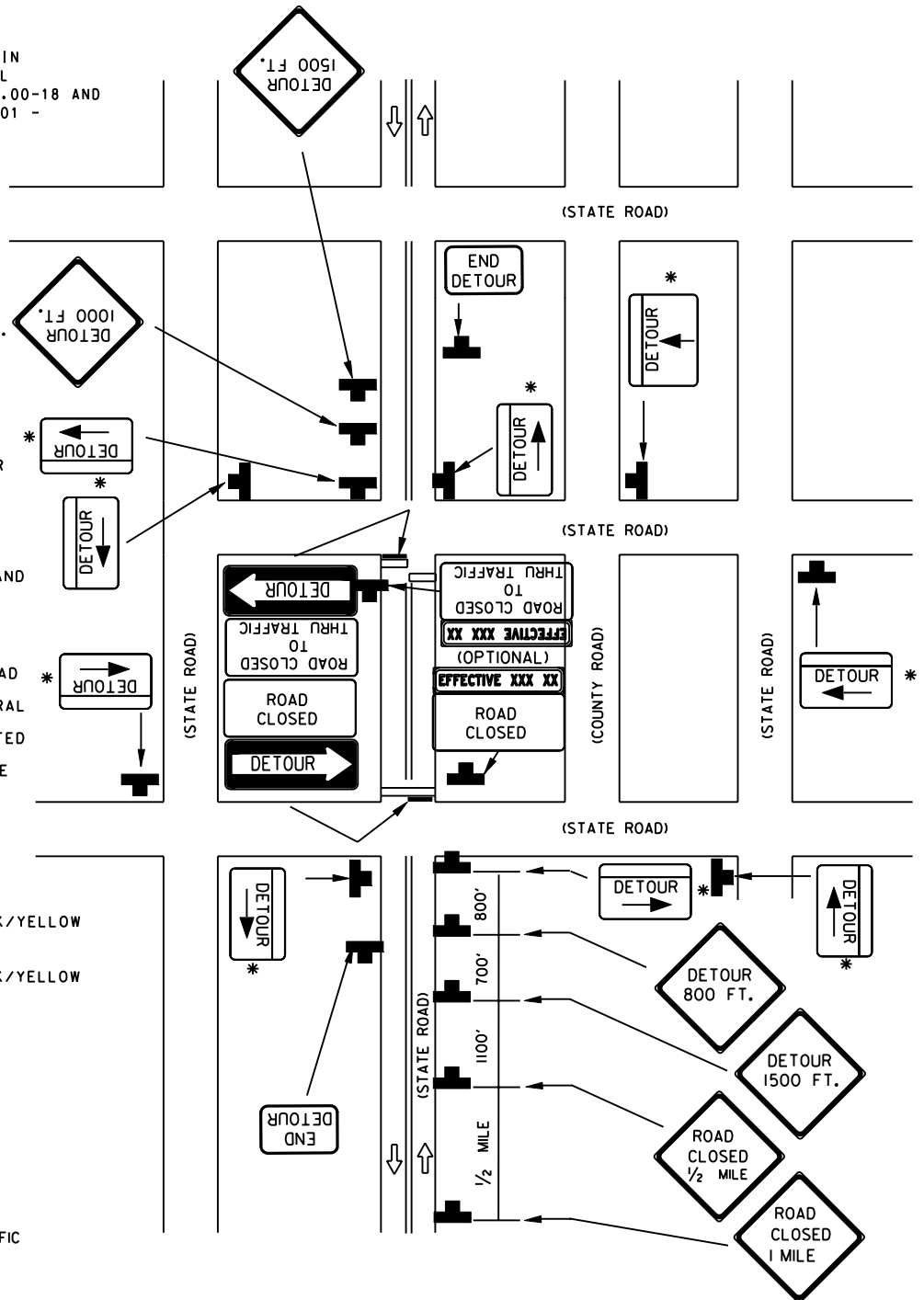

SPECIFICATION <b>104</b>	CATEGORY CODE ITEMS
-----------------------------	---------------------

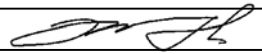
APPROVED   
DIRECTOR - OFFICE OF TRAFFIC AND SAFETY

 State Highway Administration	APPROVAL • SHA REVISIONS	APPROVAL • FEDERAL HIGHWAY ADMINISTRATION
	APPROVAL <b>8-20-03</b>	APPROVAL <b>9-23-03</b>
	REVISED <b>8-11-10</b>	REVISED <b>7-29-10</b>
	REVISED	REVISED
	REVISED	REVISED

**Maryland Department of Transportation**  
**STATE HIGHWAY ADMINISTRATION**  
STANDARDS FOR HIGHWAYS AND INCIDENTAL STRUCTURES

**DETOUR SIGNING FOR CLOSED STREET /2-LANE, 2-WAY  
GREATER THAN 40 MPH /OVER 12 HRS. OR NIGHTTIME USE**

**STANDARD NO. MD 104.06-06**