

TEMPORARY TRAFFIC CONTROL TYPICAL APPLICATION

REDUCED OVERHANG SIGN OPTIONS

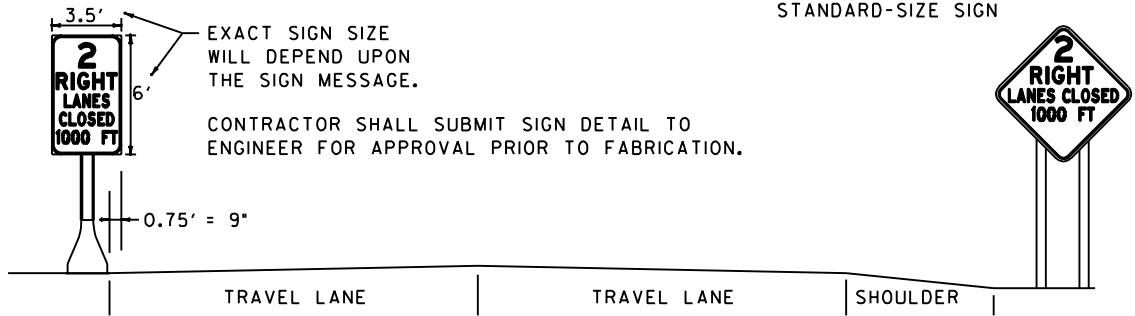

Option 1 (Rectangular Sign)

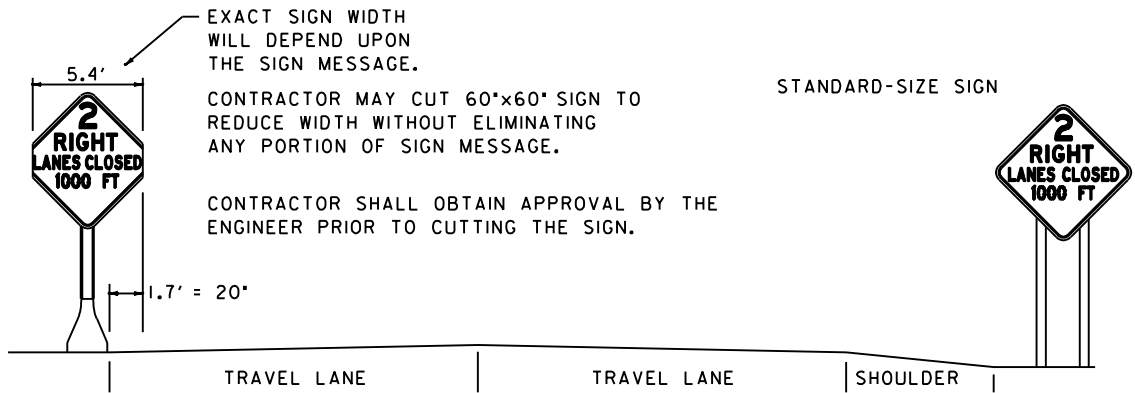

Option 2 (60"x60" (Original Size), with Corners Cut Off)

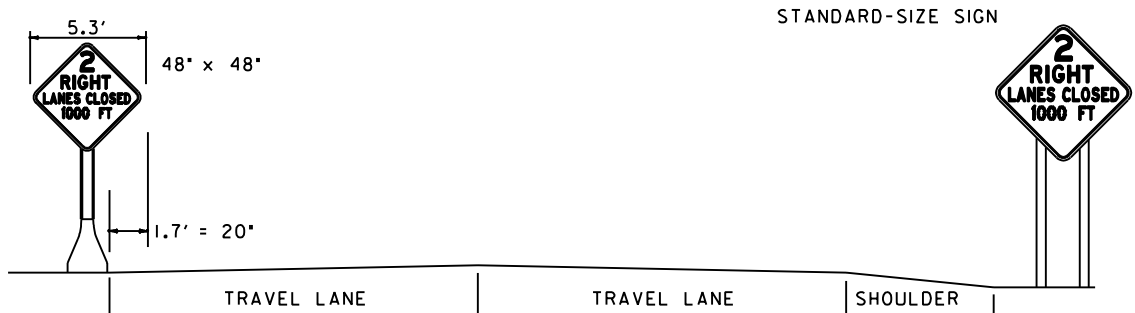

Option 3 (48"x48", Diamond-Shaped Sign)

NOTES:

THESE OPTIONS MAY ONLY BE USED IN CASES WHERE RESTRICTED LATERAL CLEARANCE EXISTS, OR SIGN OVERHANG MAY OTHERWISE RESULT IN UNSAFE DRIVING CONDITIONS.

TEXT SIZE MAY NEED TO BE REDUCED TO FIT WITHIN SIGN BORDER, AS APPROVED BY THE ENGINEER.

SPECIFICATION	CATEGORY CODE ITEMS	<p style="font-size: 1.2em; font-weight: bold;">Maryland Department of Transportation</p> <p style="font-size: 1.2em; font-weight: bold;">STATE HIGHWAY ADMINISTRATION</p> <p>STANDARDS FOR HIGHWAYS AND INCIDENTAL STRUCTURES</p> <p style="font-weight: bold;">BARRIER-MOUNTED WARNING SIGN OPTIONS FOR RESTRICTED LATERAL CLEARANCE CONDITIONS</p> <p style="font-weight: bold;">STANDARD NO. MD 104.01-32</p>
APPROVED	 DIRECTOR - OFFICE OF TRAFFIC AND SAFETY	
APPROVAL • SHA REVISIONS APPROVAL 8-20-03 REVISED REVISED REVISED	APPROVAL • FEDERAL HIGHWAY ADMINISTRATION APPROVAL 9-23-03 REVISED REVISED REVISED	
APPROVAL • SHA REVISIONS APPROVAL 8-20-03 REVISED REVISED REVISED		