

# TEMPORARY TRAFFIC CONTROL TYPICAL APPLICATION

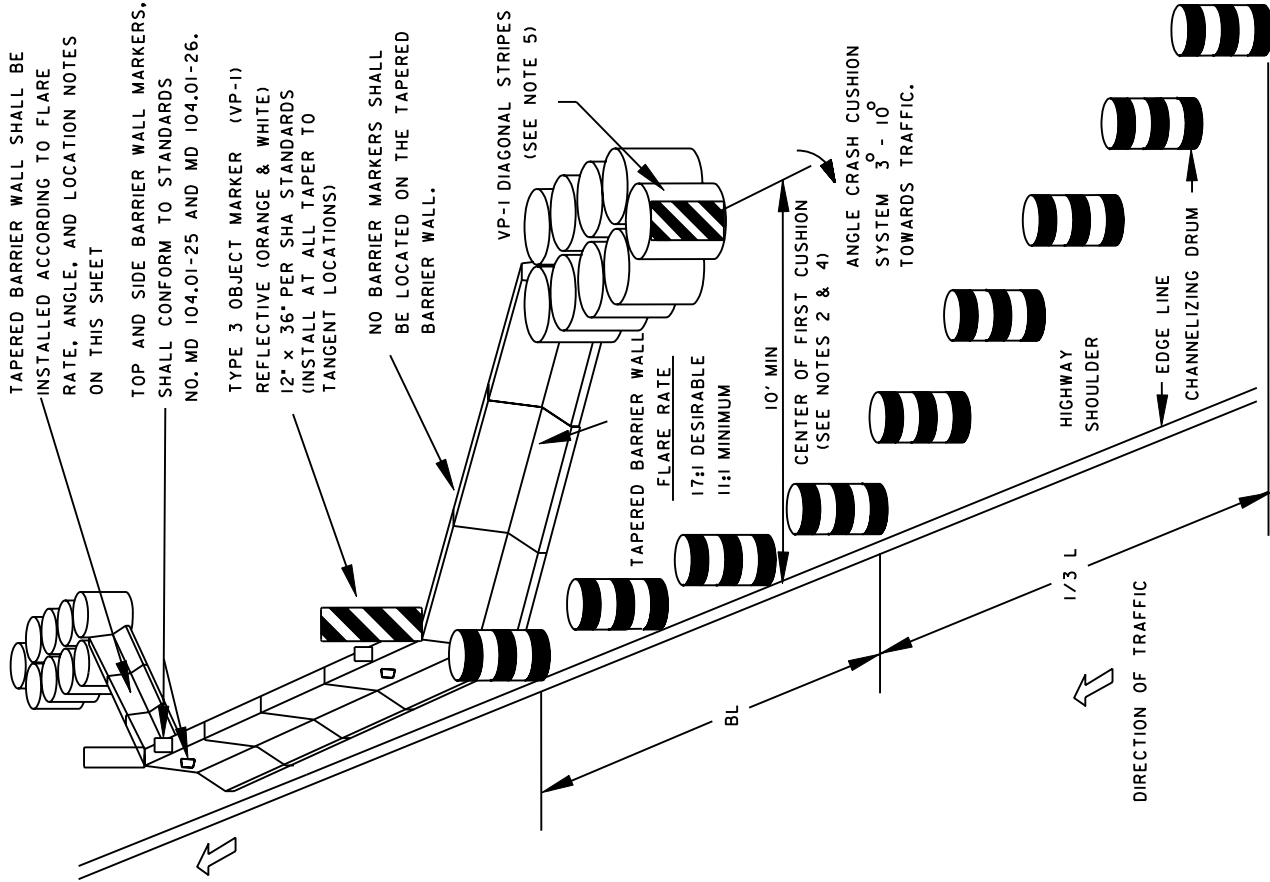

**NOTES:**

1. TEMPORARY EDGE LINE STRIPING -
  - TEMPORARY EDGE LINE STRIPING IS OPTIONAL ALONG THE ENTIRE LENGTH OF TANGENT BARRIER WALL UNLESS OTHERWISE SPECIFIED.
  - THE EDGE LINE SHALL BE REQUIRED WHERE BARRIER WOULD NOT BE TANGENT TO, OR WOULD BE TANGENT TO, BUT NOT WITHIN 2' OF PROJECTED EDGE LINE.
  - TEMPORARY EDGE LINE STRIPING SHALL BE REQUIRED ALONG THE TANGENT BARRIER WALL FOR A DISTANCE OF 100' PAST THE BEGINNING OF THE TANGENT SECTIONS.
  - THE EDGE LINE SHOULD BE PLACED 8" - 12" FROM AND ALONG THE BARRIER, WHEN POSSIBLE.
2. WHERE SPACE IS LIMITED AN END TREATMENT MAY BE INSTALLED AS APPROVED BY THE ENGINEER.
3. THE SLOPED END BARRIER TRANSITION IS NOT PERMITTED ON ANY ROADWAY WHERE THE TRAVEL SPEED IS GREATER THAN 25 MPH.
4. UNLESS CONDITIONS DETERMINE OTHERWISE, AS DETERMINED BY THE ENGINEER
5. REFLECTORIZATION IS REQUIRED ON INITIAL CRASH CUSHION. USE VP-1 WITH DIAGONAL STRIPES.
6. ON TWO-LANE, TWO-WAY ROADWAYS, THE TWO-WAY TRAFFIC TAPER SHALL BE A MINIMUM OF 100'.
7. TAPERED BARRIER WALL MAY BE CONNECTED TO EXISTING W BEAM AS DIRECTED BY THE ENGINEER. REFER TO CATEGORY I OF THE BOOK OF STANDARDS FOR RELEVANT STANDARD DETAILS(S).
8. IF THE TRAILING END OF THE BARRIER IS WITHIN THE CLEAR ZONE (REFER TO CLEAR ZONE CHART IN GENERAL NOTES), BARRIER PROTECTION IS REQUIRED.
9. THERE SHALL BE A MINIMUM OF SEVEN CHANNELIZING DEVICES IN THE SHOULDER TAPER.

SPECIFICATION <b>104</b>	CATEGORY CODE ITEMS
APPROVED	 DIRECTOR - OFFICE OF TRAFFIC AND SAFETY
 <b>State Highway Administration</b>	APPROVAL • SHA REVISIONS
	APPROVAL • FEDERAL HIGHWAY ADMINISTRATION
	APPROVAL <b>8-20-03</b>
	APPROVAL <b>9-23-03</b>
REVISED <b>3-15-06</b>	REVISED
REVISED <b>8-11-10</b>	REVISED <b>10-14-10</b>
REVISED	REVISED

**Maryland Department of Transportation**  
**STATE HIGHWAY ADMINISTRATION**  
 STANDARDS FOR HIGHWAYS AND INCIDENTAL STRUCTURES  
**ADVANCE CHANNELIZATION AND PROTECTION**  
**FOR BARRIER FLARE SECTION**  
**STANDARD NO. MD 104.01-23 B**